



History of the Airstream 190 B-Van Motorhome

Airstream broke into the small motorhome market on July 1, 1988, when it produced the first Airstream 190 B-Van. Airstream manufactured the 190 B-Van motorhome from 1988 (model year 1989) until 1999 (model year 2000). The B-Van was 19 feet in length and was built on a Ford E350 Cargo Van chassis. It included such features as a lavatory, convertible couch with seat belts, galley, and over-cab bunk. All of the interior furniture was designed to reflect the "Airstream style" present in its travel trailers. From 1989 to 1996, the standard engine on the B-Van was 351 cubic inches, with the option for a 460 cubic-inch engine. Originally, the fiberglass top, manufactured by Okanagan, had two front windows, but the style was changed to take a single, large front window in 1990.

For the 1997 model year, the B-Van underwent a number of improvements. First, the new engine used was a 6.8-liter Triton V-10 engine, which came standard on all vans. In addition, the floor plan was redesigned: the stove moved to the curbside, creating a six-foot-long galley, and the toilet and shower were combined to create a wet bath. A sink was also added to the wet bath. Airstream added exterior storage to the unit and increased aerodynamics for the cab-over design. According to the advertisement for the 1997 model year, Airstream "made more than 20 great improvements" on the B-Van's design.

The final B-Van was completed on August 1, 1999, bringing the total number of units produced in 11 years to 1393.

Historical Timeline of the B-Van

1988

- First Airstream 190 B-Van produced in Jackson Center, Ohio (model year 1989).
- 351 cubic inch engine (STD) 460 cubic inch engine (OPT)



1989

- Design of over-cab bunk changed from two front windows to one (for model year 1990)

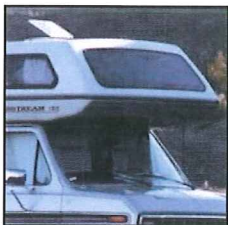

1991

- B-Van's top remodeled to be slightly smaller

1992

- Ford E350 chassis redesigned to include a more streamlined grill pattern



1995

- Floor plan redesigned: stove moved to curbside, refrigerator moved to roadside (for 1996 model year)
- New option for microwave over refrigerator

1996

- First B-Van produced with 6.8-liter Triton V-10 engine (now standard on all B-Vans, model year 1997 and newer)



- Lavatory redesigned to create a wet bath with added sink.
- Galley sink moved next to stove to create larger section of counter space.

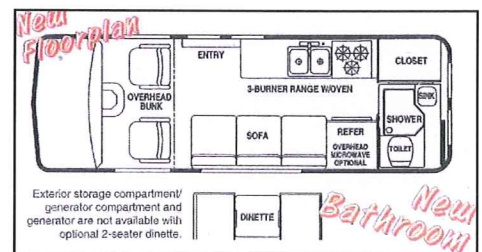

- New option for 2-seater dinette.

1999

- Final B-Van completed August 1 (model year 2000).

1989 AIRSTREAM 19' TYPE B

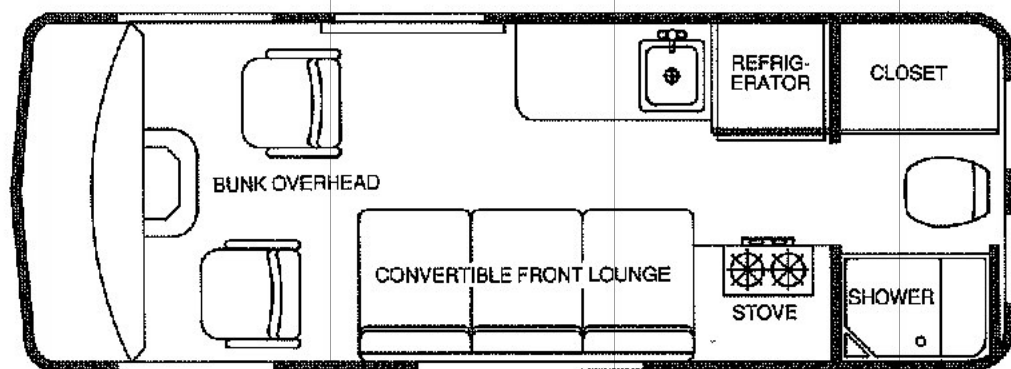

Specifications

Standard Chassis

Ford 8100 GVWR E250 Cargo Van
138" wheelbase
351 cu. in.
41 gal. (155 L) dual fuel tanks
354 rear end ratio

Approximate Dimensions

Length 215"
Width 79.7"
Height 111"

Optional Chassis

Ford 9100 GVWR E350 Cargo Van
138" wheelbase
460 cu. in.
41 gal. (155 L) dual fuel tanks
354 rear end ratio

Specifications & Equipment

Exterior Features

- Aerodynamic raised fiberglass top, color matched to van
- Color coordinated accent paint
- Chrome front & rear bumpers
- Tinted, slide-open safety glass windows w/screens
- Rear ladder
- Rack-type roof antenna w/jack
- Matching fiberglass running boards
- Continental kit w/spare tire & bracket

Automotive Equipment

- Automatic transmission
- Tilt steering wheel
- Cruise control
- Dash air conditioner
- AM/FM radio w/cassette and speakers
- Convenience group package
- Hi-back bucket seats
- Trailer towing package

Systems

- 12 volt interior lighting
- 25' power cord 110v service
- 30 amp converter w/12 volt charger
- Pre-wired for roof air conditioning
- 22.4 gallon fresh water
- 6 gal. quick recovery hot water heater
- 18.4 gal. waste water holding tank
- Demand water pump system
- 35# LPG tank
- 12,000 BTU furnace
- 3 cu. ft. Dometic refrigerator
- 2 burner range top
- Power range hood w/light
- 12 volt roof vent
- City water hook-up
- Lockable water tank fill
- Control panel monitoring system

To provide the best possible product, we reserve the right to improve and/or modify the product which may change the features and specifications. Check with your Airstream dealer for updated information and availability.

Living Area & Construction

- Inner fiberglass liner top w/insulation
- Oak hardwood frames & doors
- Oak vinyl paneling
- Side-walls insulated
- Tub/Shower area w/foldette door
- Rear curbside closet
- Storage below range top cabinet
- Countertop area over refrigerator
- Cabinet storage over galley
- Galley w/drawers (formica countertop)
- Cabinet storage over sofa
- Stainless steel sink w/high rise faucet
- Convertible sofa
- Drop-in table
- 72" x 76" sleeping area over cab
- Bunk ladder
- Carpet throughout
- Vinyl floor covering (bathroom area)
- Deluxe driver & passenger seats
- Trim panels on all doors
- Fire extinguisher
- Gas detector (LPG)
- Sewer drain hose & holder

Optional Equipment

- Upgrade fabric package
 1. Nutmeg
 2. Sunset
 3. Cameo
- Generator 2.8 KW
- 7,000 BTU 110 volt roof air conditioner w/heat strip
- Sport wheel cover
- Towing package (receiver and wiring)
- Awning
- Power seat driver
- Power seat passenger
- Microwave
- (4) Burner range with oven
- 9" color television
- VCR
- Deluxe engine cover console
- Trailer towing mirror extension

Made in the USA 

1989

STANDARD FEATURES 1989 - 190 MOTORHOME

3/1/89

EXTERIOR FEATURES

AERODYNAMIC RAISED FIBERGLASS TOP, COLOR
MATCHED TO VAN
COLOR COORDINATED ACCENT PAINT
CHROME FRONT & REAR BUMPERS
TINTED, SLIDE-OPEN SAFETY GLASS
WINDOWS W/SCREENS
REAR LADDER
ROOF RACK-TYPE ANTENNA W/JACK
MATCHING FIBERGLASS RUNNING BOARDS
CONTINENTAL KIT W/SPARE TIRE & BRACKET

AUTOMOTIVE EQUIPMENT

AUTOMATIC TRANSMISSION
TILT STEERING WHEEL
CRUISE CONTROL
DASH AIR CONDITIONER
AM/FM RADIO/CASSETTE & SPEAKERS
CONVENIENCE GROUP PACKAGE
HIGH-BACK BUCKET SEATS

SYSTEMS

12 VOLT INTERIOR LIGHTING
25' POWER CORD 110V SERVICE
30 AMP CONVERTER W/12 VOLT CHARGER
PRE-WIRED FOR ROOF AIR CONDITIONING
22.4 GALLON FRESH WATER
6 GALLON QUICK RECOVERY HOT WATER HEATER
18.4 GALLON WASTE-GREY WATER HOLDING TANK
DEMAND WATER PUMP SYSTEM
35 LB LPG
12,000 BTU FURNACE
3 CU FT DOMETIC REFRIGERATOR
2-BURNER RANGE TOP
POWER RANGE HOOD W/LIGHT
12 VOLT ROOF VENT
CITY WATER HOOK-UP
LOCKABLE WATER TANK FILL
CONTROL PANEL MONITORING SYSTEM

LIVING AREA & CONSTRUCTION

INNER FIBERGLASS LINER TOP WITH INSULATION
OAK HARDWOOD FRAMES & DOORS
OAK VINYL PANELING
SIDE-WALLS INSULATED
TUB/SHOWER AREA WITH FOLDETTE
REAR CURBSIDE CLOSET
RANGE TOP CABINET STORAGE BELOW
COUNTERTOP AREA OVER REFRIGERATOR
CABINET STORAGE OVER SOFA
STAINLESS STEEL SINK W/HIGH RISE FAUCET
CONVERTIBLE SOFA WITH SEAT BELTS
DROP-IN TABLE
72" X 76" SLEEPING AREA OVER CAB
BUNK LADDER
CARPET THROUGHOUT (EXCEPT BATHROOM)
VINYL FLOOR COVERING (BATHROOM AREA)
DELUXE DRIVER & PASSENGER SEATS
TRIM PANELS ON ALL DOORS
FIRE EXTINGUISHER
GAS DETECTOR (LPG)
SEWER DRAIN HOSE & HOLDER
OZITE CEILING
MEDICINE CABINET WITH MIRROR

STANDARD CHASSIS

FORD 9100 GVWR E350 CARGO VAN
138" WHEELBASE
41 GAL (155L) DUAL FUEL TANKS
354 REAR END RATIO

1990 AIRSTREAM 19' MOTOR HOME

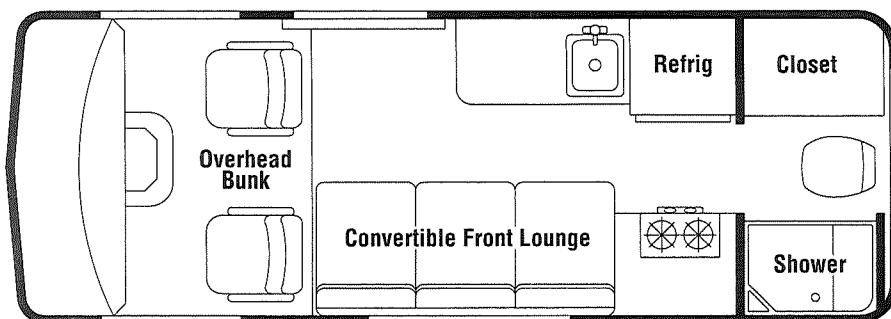

General Specifications

Standard Chassis

Ford	9000 Lb. GVWR E350 Cargo Van
	7600 Lb. approx. wt. (with fuel)
	138" wheelbase
	351 cu. in.
	41 gal. dual fuel tanks
	3.54 rear end ratio
	LT-235/85R16 tire size

Approximate Dimensions

Ford	Length	228"
	Width	75.5"
	Height	113" (with Air Conditioning 119")

Airstream constantly strives to improve its product. All specifications are subject to change without notice. Each vehicle comes with a one year warranty. Printed in U.S.A. © Airstream, Inc. 1990

AIRSTREAM

1 9 0 S E R I E S

THOR Made in the U.S.A. 

419 W. Pike St. Jackson Center OH 45334 Telephone 513 596-6111

Specifications & Standard Equipment

Exterior Features

- New Aerodynamic raised fiberglass top, color matched to van with front one piece window
- 1990 exterior graphics
- Chrome front & rear bumpers
- Tinted, slide-open safety glass windows with screens
- Rear ladder
- Rack-type roof antenna with jack
- Color coordinated ground effect running boards
- Continental kit with spare tire & bracket
- Exterior storage or generator compartment
- Center brake light

Automotive Equipment

- Automatic transmission
- Tilt steering wheel
- Cruise control
- Dash air conditioner
- AM/FM stereo, radio with cassette and speakers
- Convenience group package
- Hi-back bucket seats

Systems

- 12 volt interior lighting
- 25' power cord for 110v service
- 30 amp converter with 12 volt charger
- Pre-wired for roof air conditioning
- 6 gallon quick recovery hot water heater
- Demand water pump system
- 35# LPG tank
- 12,000 BTU furnace
- 3 cu. ft. Dometic refrigerator
- 2 burner range top
- Power range hood with light
- 12 volt roof vent
- City water hook-up
- Lockable water tank fill
- Control panel monitoring system
- 22.4 gallon fresh water tank
- 16.2 gallon grey water tank
- 16.2 gallon black water tank

Living Area and Construction

- Oak hardwood frames and doors
- Oak vinyl paneling
- Side-walls insulated
- Tub/shower area with foldette door
- Rear curbside closet
- Storage below range top cabinet
- Countertop area over refrigerator
- Cabinet storage over galley
- Galley with drawers (formica countertop)
- Cabinet storage over sofa
- Stainless steel sink with high rise faucet
- Convertible sofa with seat belts
- Drop-in table
- 72" x 76" sleeping area over cab
- Bunk ladder
- Carpet throughout (except bathroom)
- Vinyl floor covering (bathroom area)
- Trim panels on all doors
- Fire extinguisher
- Gas detector (LPG)
- Sewer drain hose compartment
- Ozite Ceiling
- Medicine cabinet with mirror

Optional Equipment

- Fabric Selections:
 1. Malibu Sand
 2. Sunset Blue
 3. True Blue
- 460 Ford, 9000 Lb. GVWR, with 4.10 Rear End Ratio
- Generator 2.8 KW
- 11,000 BTU roof air conditioner w/heat strip
- Front Spoiler with Drivers Lights
- Sport wheel cover
- Towing package (receiver and wiring)
- Awning
- Power seat driver
- Power seat passenger
- Microwave
- (4) Burner range with oven
- Deluxe engine cover console
- Trailer towing mirror extension
- Styled aluminum wheels
- Upgrade Flexsteel seat package
- TV Antenna Booster
- Bath Exhaust Fan

AIRSTREAM 19' MOTORHOME

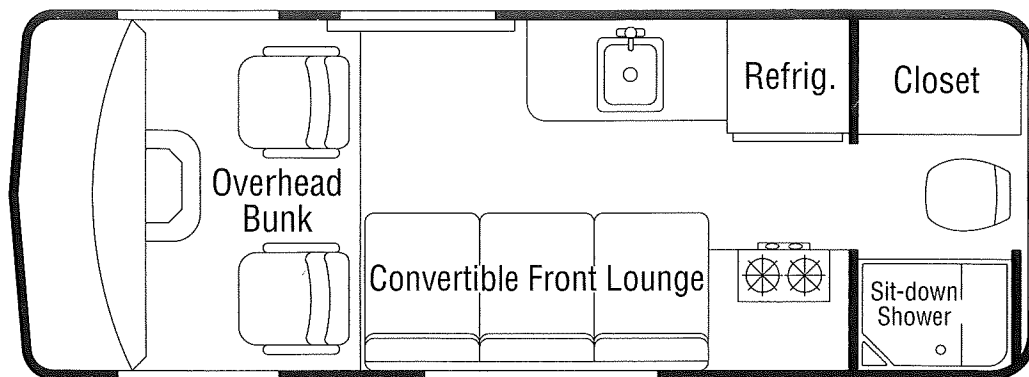

Specifications & Standard Equipment

Standard Chassis (Ford)

- 9400 Lb. GVWR E350 Cargo Van
- 7600 Lb. approx. wt. (with fuel)
- 138" Wheelbase
- 351 cu. in. engine
- 35 gallon fuel tank
- 3.54 rear end ratio
- LT-245/75R x 16E, BSW all season tires

Dimensions:

- Length: 19'
- Width: 6' 3 1/2"
- Height: 9' 5" (w/Air 9' 11")

Automotive Equipment

- Automatic transmission/overdrive
- Tilt steering wheel
- Cruise control
- Dash air conditioner
- AM/FM stereo radio w/cassette and speakers
- Convenience group package
- Hi-back bucket seat
- Deluxe engine cover console
- Power mirrors (Silver Exterior)

Systems

- 12 volt interior lighting
- 35' power cord for 110-volt service
- 30 amp converter w/12-volt charger
- Pre-wired for roof air conditioning
- 6-gal. quick-recovery hot water heater
- Demand water pump system
- 35# LPG tank
- 12,000 BTU furnace
- 3 cu. ft. Dometic® refrigerator (3-way)
- 2-burner range top
- Power range hood w/light
- 12-volt roof vent
- City water hook-up
- Lockable water tank fill
- Control panel monitoring system with LP gauge
- 22.4 gallon fresh-water tank
- 20 gallon grey-water tank
- 21 gallon black-water tank
- Pre-wired for solar battery charger

Living Area & Construction

- Oak hardwood frames & doors
- Oak vinyl paneling
- Side-walls insulated
- Sit down shower area w/foldette door
- Bath exhaust fan
- Rear curbside closet
- Storage below range top cabinet
- Countertop area over refrigerator
- Cabinet storage over galley
- Galley w/drawers (formica countertop)
- Cabinet storage over sofa
- Stainless steel sink w/high-rise faucet
- 72" x 40" Convertible sofa w/seat belts
- Drop-in table
- 72" x 76" sleeping area over cab
- Bunk ladder
- Carpet throughout (except bathroom)
- Vinyl floor covering (bathroom area)
- Trim panels on all doors
- Fire extinguisher
- Sewer drain hose compartment
- Ozite ceiling
- Medicine cabinet w/mirror
- Reading lights over sofa
- Smoke detector

Exterior Features

- Aerodynamic raised fiberglass top, color matched to van w/1-piece front window
- Stylish exterior graphics
- Chrome front & rear bumpers
- Tinted, slide-open safety glass windows w/screens
- Rear ladder
- Rack-type roof antenna w/jack
- Color coordinated ground effect running boards
- Continental kit w/spare tire & bracket
- Exterior storage or generator compartment
- Center brake light
- Porch light
- Sport wheel covers

To provide the best possible product, we reserve the right to improve and/or modify the product which may change the features and specifications. Check with your Airstream dealer for updated information and availability.

Optional Equipment

- Fabric Selections
- 460 cu. in. engine
- 7.3 Liter Diesel (LP generator optional)
- Generator 2.8 KW w/hour meter
- 11,000 BTU roof air conditioner w/heat strip
- Driving lights
- Towing package (receiver and wiring)
- Awning
- Power seat, driver
- Power seat, passenger
- Microwave
- 4-burner range w/oven
- Black shadow aluminum wheels
- Upgrade Flexsteel® seat package
- TV antenna booster w/cable TV and telephone hook-up
- Water purifier w/separate faucet
- Solar battery charger
- Fantastic® roof vent
- CB radio
- Galley flip-up shelf

1991



AIRSTREAM

419 W. Pike St., Jackson Center, OH 45334 Telephone 513/596-6111

AIRSTREAM 19' MOTORHOME

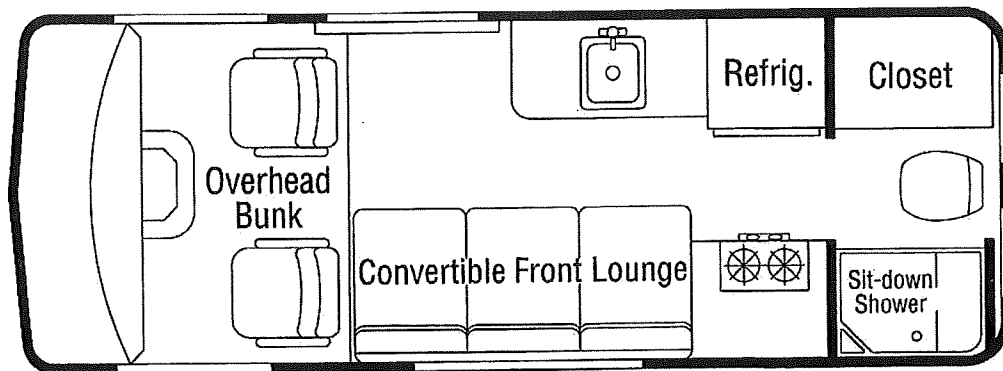

Specifications & Standard Equipment

Standard Chassis (Ford)

- 9400 Lb. GVWR E350 Cargo Van
- 7600 Lb. approx. wt. (with fuel)
- 138" Wheelbase
- 351 cu. in. engine
- 35 gallon fuel tank
- 3.54 rear end ratio
- LT-245/75R x 16E, BSW all season tires

Dimensions:

- Length: 19'
- Width: 6' 3 1/2"
- Height: 9' 5" (w/Air 9' 11")

Automotive Equipment

- Automatic transmission/overdrive
- Tilt steering wheel
- Cruise control
- Dash air conditioner
- AM/FM stereo radio w/cassette and speakers
- Convenience group package
- Hi-back bucket seat
- Deluxe engine cover console
- Power mirrors (Silver Exterior)

Systems

- 12 volt interior lighting
- 35' power cord for 110-volt service
- 30 amp converter w/12-volt charger
- Pre-wired for roof air conditioning
- 6-gal. quick-recovery hot water heater
- Demand water pump system
- 35# LPG tank
- 12,000 BTU furnace
- 3 cu. ft. Dometic® refrigerator (3-way)
- 2-burner range top
- Power range hood w/light
- 12-volt roof vent
- City water hook-up
- Lockable water tank fill
- Control panel monitoring system with LP gauge
- 22.4 gallon fresh-water tank
- 20 gallon grey-water tank
- 21 gallon black-water tank
- Pre-wired for solar battery charger

Living Area & Construction

- Oak hardwood frames & doors
- Oak vinyl paneling
- Side-walls insulated
- Sit down shower area w/foldette door
- Bath exhaust fan
- Rear curbside closet
- Storage below range top cabinet
- Countertop area over refrigerator
- Cabinet storage over galley
- Galley w/drawers (formica countertop)
- Cabinet storage over sofa
- Stainless steel sink w/high-rise faucet
- 72" x 40" Convertible sofa w/seat belts
- Drop-in table
- 72" x 76" sleeping area over cab
- Bunk ladder
- Carpet throughout (except bathroom)
- Vinyl floor covering (bathroom area)
- Trim panels on all doors
- Fire extinguisher
- Sewer drain hose compartment
- Ozite ceiling
- Medicine cabinet w/mirror
- Reading lights over sofa
- Smoke detector

Exterior Features

- Aerodynamic raised fiberglass top, color matched to van w/1-piece front window
- Stylish exterior graphics
- Chrome front & rear bumpers
- Tinted, slide-open safety glass windows w/screens
- Rear ladder
- Rack-type roof antenna w/jack
- Color coordinated ground effect running boards
- Continental kit w/spare tire & bracket
- Exterior storage or generator compartment
- Center brake light
- Porch light
- Sport wheel covers

To provide the best possible product, we reserve the right to improve and/or modify the product which may change the features and specifications. Check with your Airstream dealer for updated information and availability.

Optional Equipment

- | | | |
|--|--|--|
| <ul style="list-style-type: none"> • Fabric Selections • 460 cu. in. engine • 7.3 Liter Diesel (LP generator optional) • Generator 2.8 KW w/hour meter • 11,000 BTU roof air conditioner w/heat strip • Driving lights • Towing package (receiver and wiring) | <ul style="list-style-type: none"> • Awning • Power seat, driver • Power seat, passenger • Microwave • 4-burner range w/oven • Black shadow aluminum wheels • Upgrade Flexsteel® seat package | <ul style="list-style-type: none"> • TV antenna booster w/cable TV and telephone hook-up • Water purifier w/separate faucet • Solar battery charger • Fantastic® roof vent • CB radio • Galley flip-up shelf |
|--|--|--|

1992



AIRSTREAM

419 W. Pike St., Jackson Center, OH 45334 Telephone 513 596-6111

AIRSTREAM 19' MOTORHOME

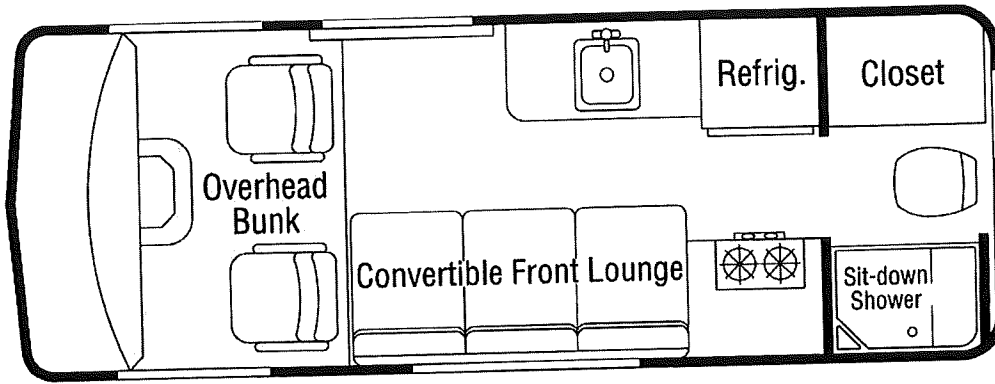

Specifications & Standard Equipment

Standard Chassis (Ford)

- 9400 Lb. GVWR E350 Cargo Van
- 7600 Lb. approx. wt. (with fuel)
- 138" Wheelbase
- 351 cu. in. engine
- 35 gallon fuel tank
- 3.54 rear end ratio
- LT-245/75R x 16E, BSW all season tires

Dimensions:

- Length: 19'
- Width: 6' 3 1/2"
- Height: 9' 5" (w/Air 9' 11")

Automotive Equipment

- Automatic transmission/overdrive
- Tilt steering wheel
- Cruise control
- Dash air conditioner
- AM/FM stereo radio w/cassette and speakers
- Convenience group package
- Hi-back bucket seat
- Deluxe engine cover console
- Power mirrors

Systems

- 12 volt interior lighting
- 35' power cord for 110-volt service
- 30 amp converter w/12-volt charger
- Pre-wired for roof air conditioning
- 6-gal. water heater/DSI
- Demand water pump system
- 35# LPG tank
- 12,000 BTU furnace
- 3 cu. ft. Dometic® refrigerator (3-way)
- 2-burner range top
- Power range hood w/light
- 12-volt roof vent
- City water hook-up
- Lockable water tank fill
- Control panel monitoring system with LP gauge
- 22.4 gallon fresh-water tank
- 20 gallon grey-water tank
- 21 gallon black-water tank
- Pre-wired for solar battery charger

Living Area & Construction

- Oak hardwood frames & doors
- Oak vinyl paneling
- Side-walls insulated
- Sit down shower area w/foldette door
- Bath exhaust fan
- Rear curbside closet
- Storage below range top cabinet
- Countertop area over refrigerator
- Cabinet storage over galley
- Galley w/drawers (formica countertop)
- Cabinet storage over sofa
- Stainless steel sink w/high-rise faucet
- 72" x 40" Convertible sofa w/seat belts
- Drop-in table
- 72" x 76" sleeping area over cab
- Bunk ladder
- Carpet throughout (except bathroom)
- Vinyl floor covering (bathroom area)
- Trim panels on all doors
- Fire extinguisher
- Sewer drain hose compartment
- Ozite ceiling
- Medicine cabinet w/mirror
- Reading lights over sofa
- Smoke detector

Exterior Features

- Aerodynamic raised fiberglass top, color matched to van w/1-piece front window
- Stylish exterior graphics
- Chrome front & rear bumpers
- Tinted, slide-open safety glass windows w/screens
- Rear ladder
- Rack-type roof antenna w/jack
- Color coordinated ground effect running boards
- Continental kit w/spare tire & bracket
- Exterior storage or generator compartment
- Center brake light
- Porch light
- Sport wheel covers

To provide the best possible product, we reserve the right to improve and/or modify the product which may change the features and specifications. Check with your Airstream dealer for updated information and availability.

Optional Equipment

- Fabric Selections
- 460 cu. in. engine
- 7.3 Liter Diesel (LP generator optional)
- Generator 2.8 KW w/hour meter
- 11,000 BTU roof air conditioner w/heat strip
- Driving lights
- Towing package (receiver and wiring)

- Awning
- Power seat, driver
- Power seat, passenger
- Microwave
- 4-burner range w/oven
- Black shadow aluminum wheels
- Upgrade Flexsteel® seat package

- TV antenna booster w/cable TV and telephone hook-up
- Water purifier w/separate faucet
- Fantastic® roof vent
- CB radio
- Galley flip-up shelf
- 110 V exterior outlet

1993

THOR
AMERICA'S BEST RV VALUE

REVISED 10/92

AIRSTREAM

419 W. Pike St., Jackson Center, OH 45334 Telephone 513/596-6111

EXTERIOR FEATURES

Aerodynamic Raised Fiberglass Top w/Front 1 pc.
Window, Color Matched To Van
1993 Exterior Graphics
Chrome Front & Rear Bumpers
Tinted, Slide-Open Safety Glass Windows w/Screens
Rear Ladder
Roof Rack-Type Antenna w/Jack
Color Coordinated Ground Effect Running Boards
Continental Kit w/Spare Tire & Bracket
Exterior Storage/Generator Compartment
Center Brake Light
Sport Wheel Covers

AUTOMOTIVE EQUIPMENT

Swing Out Glass Side, Rear, Cargo Doors
Windshield Wipers, Interval
Power Door Locks & Windows
Tilt Steering Wheel
Cruise Control
Dash Air Conditioner
AM/FM/Cassette & Speakers
Convenience Group Package
High-Back Bucket Seats
Deluxe Engine Cover Console

SYSTEMS

12 Volt Interior Lighting
25' Power Cord 110V Service
30 Amp Converter w/12 Volt Charger
Pre-Wired For Roof Air Conditioning
22.4 Gallon Fresh Water
6 Gallon Quick Recovery Hot Water Heater
20 Gallon Grey Water Tank
21 Gallon Black Water Tank
Demand Water Pump System
9.8 Gallon LPG Tank
12,000 BTU Furnace
3 Cu. Ft. Dometic® Refrigerator
2-Burner Range Top
Power Range Hood w/Light
12 Volt Roof Vent
City Water Hook-Up
Lockable Water Tank Fill
Control Panel Monitoring System
Porch Light
Pre-Wire for Solar Battery Charger

LIVING AREA & CONSTRUCTION

Oak Hardwood Frames & Doors
Oak Vinyl Paneling
Insulated Side-Walls
Tub/Shower Area w/Foldette Door
Bathroom Exhaust Fan
Rear C.S. Closet
Range Top w/Pan Storage Below
Countertop Area Over Refrigerator
Cabinet Storage Over Sofa
Stainless Steel Sink w/High-Rise Faucet
Convertible Sofa w/Seat Belts
Drop-In Table
72" x 76" Sleeping Area Over Cab
Bunk Ladder
Carpet Throughout (Except Bathroom)
Vinyl Floor Covering (Bathroom Area)
Deluxe Driver & Passenger Seats
Trim Panels on All Doors
Fire Extinguisher
Sewer Drain Hose & Holder
Ozite Ceiling
Medicine Cabinet w/Mirror

STANDARD CHASSIS

1993 Ford 9300 GVWR E350 Cargo Van
w/Automatic 4-Speed Transmission w/Overdrive
138" Wheelbase
35 Gallon (132.5L) Fuel Tank
3.54 Rear End Ratio
Handling Package
130 Amp Alternator
Insulation Package, Deluxe
LT 245/75R X 16E BSW All-Season Tires

THE AIRSTREAM 190 MOTORHOME

The Airstream 190 is truly the all-purpose RV for today's demanding lifestyles: it's a deluxe 19' motorhome, a spacious second car, and a powerful tow vehicle all in one. Full interior headroom, a complete kitchen and bath, and sleeping accommodations for four mean your family can travel in comfort and security on weekend trips or extended tours. And, just like full-sized motorhome, your interest payment may be tax deductible. Best of all, it's handcrafted by Airstream, so you know you're getting the quality and value that have made Airstream a legend for over 60 years.

1994



THOR
AMERICA'S BEST RV VALUE



This brochure is printed on recycled paper as part of Thor's corporate effort to minimize waste and conserve our natural resources. Providing safe, fuel efficient recreational vehicles is Thor's way of further demonstrating our role as the industry leader in safeguarding our nation's environment.

Standard Chassis (Ford)

- 9400 Lb. GVWR E350 Cargo Van
- 7600 Lb. approx. wt. (with fuel)
- 138" Wheelbase
- 351 cu. in. engine
- 35-gallon fuel tank
- 3.54 rear-end ratio
- LT-245/75R x 16E, BSW all season tires

Dimensions:

- Length: 19' 8"
- Width: 6' 3 1/2"
- Height: 9' 5" (w/Air 9' 11")

Automotive Equipment

- Automatic transmission/overdrive
- Tilt steering wheel
- Cruise control
- Dash air conditioner
- AM/FM stereo radio w/cassette and speakers
- Convenience group package
- Hi-back bucket seat
- Deluxe engine cover console
- Power mirrors
- Air bag in steering wheel ('95 Models)
- 4-wheel anti-lock braking system

Systems

- 12-volt interior lighting
- 35' power cord for 110-volt service
- 30 amp converter w/12-volt charger
- Pre-wired for roof air conditioning
- 6-gal. water heater/DSI
- Demand water pump system
- 9.8-gal. LPG tank
- 12,000 BTU furnace
- 3 cu. ft. Dometic® refrigerator (3-way)
- 2-burner range top
- Power range hood w/light
- 12-volt roof vent
- City water hook-up
- Lockable water tank fill
- Control panel monitoring system with LP gauge
- 22.4-gallon fresh water tank
- 20-gallon grey water tank
- 21-gallon black water tank
- Pre-wired for solar battery charger

Living Area & Construction

- Oak hardwood frames & doors
- Oak vinyl paneling
- Side-walls insulated
- Sit down shower area w/foldette door
- Bath exhaust fan
- Rear curbside closet
- Storage below range top cabinet
- Countertop area over refrigerator
- Cabinet storage over galley
- Galley w/drawers (formica countertop)
- Cabinet storage over sofa
- Stainless steel sink w/high-rise faucet
- 72" x 40" Convertible sofa w/seat belts
- Drop-in table
- 72" x 76" sleeping area over cab
- Bunk ladder
- Carpet throughout (except bathroom)
- Vinyl floor covering (bathroom area)
- Trim panels on all doors
- Fire extinguisher
- Sewer drain hose compartment
- Ozite ceiling
- Medicine cabinet w/mirror
- Reading lights over sofa
- Smoke detector
- Vinyl Ceiling w/Ozite Walls

Exterior Features

- Aerodynamic raised fiberglass top, color matched to van w/1-piece front window
- Stylish exterior graphics
- Chrome front & rear bumpers
- Tinted, slide-open safety glass
- Windows w/screens
- Rear ladder
- Rack-type roof antenna w/jack

- Color coordinated ground effect running boards
- Continental kit w/spare tire & bracket
- Exterior storage or generator compartment
- Center brake light
- Porch light
- Sport wheel covers

Options

- Fabric Selections
- 460 cu. in. engine
- Double Sink
- Generator 2.8 KW w/hour meter
- 11,000 BTU roof air conditioner w/heat strip
- Driving lights
- Towing package (receiver and wiring)
- Awning
- Power seat-driver
- Power seat-passenger
- Microwave
- 3-burner range w/oven
- Black shadow aluminum wheels
- Upgrade Flexsteel® seat package
- TV antenna booster w/cable TV and telephone hook-up
- Water purifier w/separate faucet
- Fantastic® roof vent
- CB radio
- Galley flip-up shelf
- 110-V exterior outlet
- Stow-a-way table

Since Airstream constantly strives to improve its products, All specifications are subject to change without notice.

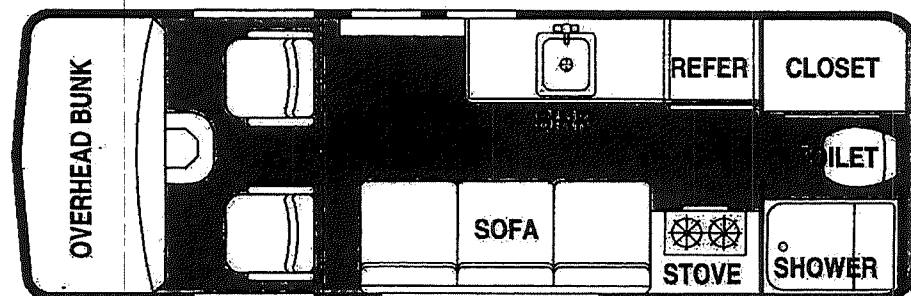

AIRSTREAM

419 W. Pike St • Jackson Center, OH 45365 • (513) 596-6111

THE AIRSTREAM 190 MOTORHOME

The Airstream 190 is truly the all-purpose RV for today's demanding lifestyles: it's a deluxe 19' motorhome, a spacious second car, and a powerful tow vehicle all in one. Full interior headroom, a complete kitchen and bath, and sleeping accommodations for four mean your family can travel in comfort and security on weekend trips or extended tours. And, just like full-sized motorhome, your interest payment may be tax deductible. Best of all, it's handcrafted by Airstream, so you know you're getting the quality and value that have made Airstream a legend for over 60 years.

1995

Standard Chassis (Ford)

- 9400 lb. GVWR E350 Cargo Van
- 7600 lb. approx. wt. (with fuel)
- 138" Wheelbase
- 351 cu. in. engine
- 35-gallon fuel tank
- 3.54 rear end ratio
- LT-245/75R x 16E, BSW all season tires

Dimensions:

- Length: 19' 8"
- Width: 6' 3 1/2"
- Height: 9' 5" (w/Air 9' 11")

Automotive Equipment

- Automatic transmission/overdrive
- Tilt steering wheel
- Cruise control
- Dash air conditioner
- AM/FM stereo radio w/cassette and speakers
- Convenience group package
- Hi-back bucket seat
- Deluxe engine cover console
- Power mirrors
- Air bag in steering wheel ('95 Models)
- 4-wheel anti-lock braking system

Systems

- 12-volt interior lighting
- 35' power cord for 110-volt service
- 30 amp converter w/12-volt charger
- Pre-wired for roof air conditioning
- 6-gal. water heater/DSI
- Demand water pump system
- 9.8-gal. LPG tank
- 12,000 BTU furnace
- 3 cu. ft. Dometic® refrigerator (3-way)
- 2-burner range top
- Power range hood w/light
- 12-volt roof vent
- City water hook-up
- Lockable water tank fill
- Control panel monitoring system with LP gauge
- 22.4-gallon fresh water tank
- 20-gallon grey water tank
- 21-gallon black water tank
- Pre-wired for solar battery charger

Living Area & Construction

- Oak hardwood frames & doors
- Oak vinyl paneling
- Side-walls insulated
- Sit down shower area w/foldette door
- Bath exhaust fan
- Rear curbside closet
- Storage below range top cabinet
- Countertop area over refrigerator
- Cabinet storage over galley
- Galley w/drawers (formica countertop)
- Cabinet storage over sofa
- Stainless steel sink w/high-rise faucet
- 72" x 40" Convertible sofa w/seat bells
- Drop-in table
- 72" x 76" sleeping area over cab
- Bunk ladder
- Carpet throughout (except bathroom)
- Vinyl floor covering (bathroom area)
- Trim panels on all doors
- Fire extinguisher
- Sewer drain hose compartment
- Ozite ceiling
- Medicine cabinet w/mirror
- Reading lights over sofa
- Smoke detector
- Vinyl Ceiling w/Ozite Walls

Exterior Features

- Aerodynamic raised fiberglass top, color matched to van w/1-piece front window
- Stylish exterior graphics
- Chrome front & rear bumpers
- Tinted, slide-open safety glass
- Windows w/screens
- Rear ladder
- Rack-type roof antenna w/jack

- Color coordinated ground effect running boards
- Continental kit w/spare tire & bracket
- Exterior storage or generator compartment
- Center brake light
- Porch light
- Sport wheel covers

Options

- Fabric Selections
- 460 cu. in. engine
- Double Sink
- Generator 2.8 KW w/hour meter
- 11,000 BTU roof air conditioner w/heat strip
- Driving lights
- Towing package (receiver and wiring)
- Awning
- Power seat—driver
- Power seat—passenger
- Microwave
- 3-burner range w/oven
- Black shadow aluminum wheels
- Upgrade Flexsteel® seat package
- TV antenna booster w/cable TV and telephone hook-up
- Water purifier w/separate faucet
- Fantastic® roof vent
- CB radio
- Galley flip-up shelf
- 110-V exterior outlet
- Stow-a-way table

GCWR
15,000 LBS

Since Airstream constantly strives to improve its products, All specifications are subject to change without notice.

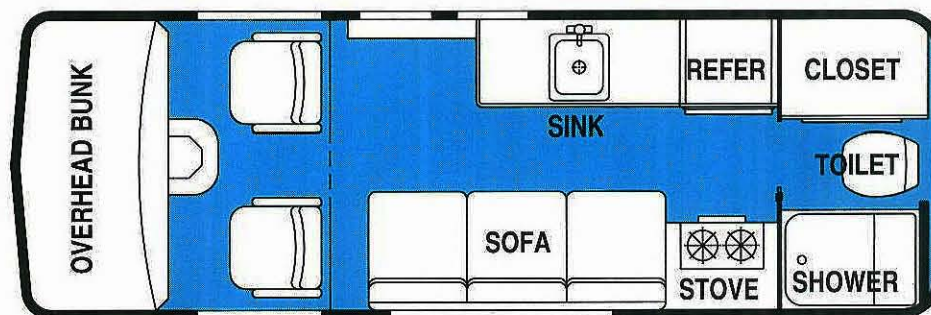

EXTERIOR FEATURES

Aerodynamic Raised Fiberglass Top w/Front 1 pc.
Window, Color Matched To Van
Exterior Graphics
Chrome Front & Rear Bumpers
Tinted, Slide-Open Safety Glass Windows w/Screens
Rear Ladder
Roof Rack-Type Antenna w/Jack
Color Coordinated Ground Effect Running Boards
Continental Kit w/Spare Tire & Bracket
Exterior Storage/Generator Compartment
Center Brake Light
Sport Wheel Covers

AUTOMOTIVE EQUIPMENT

Swing Out Glass Side, Rear, Cargo Doors
Windshield Wipers, Interval
Power Door Locks & Windows
Tilt Steering Wheel
Cruise Control
Dash Air Conditioner
AM/FM/Cassette & Speakers
Convenience Group Package
Hi-Back All Fabric Seats
Deluxe Engine Cover Console
Drivers Side Air Bag

SYSTEMS

12 Volt Interior Lighting
25' Power Cord 110V Service
30 Amp Converter w/12 Volt Charger
Pre-Wired For Roof Air Conditioning
22.4 Gallon Fresh Water
6 Gallon Quick Recovery Hot Water Heater
20 Gallon Grey Water Tank
21 Gallon Black Water Tank
Demand Water Pump System
9.8 Gallon LPG Tank
12,000 BTU Furnace
3 Cu. Ft. Dometic® Refrigerator
2-Burner Range Top
Power Range Hood w/Light
12 Volt Roof Vent
City Water Hook-Up
Lockable Water Tank Fill
Control Panel Monitoring System
Porcn Light
Pre-Wire for Solar Battery Charger

LIVING AREA & CONSTRUCTION

Oak Hardwood Frames & Doors
Oak Vinyl Paneling
Insulated Side-Walls
Tub/Shower Area w/Foldette Door
Bathroom Exhaust Fan
Rear C.S. Closet
Range Top w/Pan Storage Below
Countertop Area Over Refrigerator
Cabinet Storage Over Sofa
Stainless Steel Sink w/High-Rise Faucet
Convertible Sofa w/Seat Belts
Drop-In Table
72" x 76" Sleeping Area Over Cab
Bunk Ladder
Carpet Throughout (Except Bathroom)
Vinyl Floor Covering (Bathroom Area)
Deluxe Driver & Passenger Seats
Trim Panels on All Doors
Fire Extinguisher
Sewer Drain Hose & Holder
Ozite Ceiling
Medicine Cabinet w/Mirror

STANDARD CHASSIS

Ford 9300 GVWR E350 Cargo Van
w/Automatic 4-Speed Transmission w/Overdrive
138" Wheelbase
35 Gallon (132.5L) Fuel Tank
3.54 Rear End Ratio
Handling Package
130 Amp Alternator
Insulation Package, Deluxe
LT 245/75R X 16E BSW All-Season Tires
Anti-Lock Brakes

1996

THE AIRSTREAM 190 MOTORHOME

The Airstream 190 is truly the all-purpose RV for today's demanding lifestyles: it's a deluxe 19' motorhome, a spacious second car, and a powerful tow vehicle all in one. Full interior headroom, a complete kitchen and bath, and sleeping accommodations for four mean your family can travel in comfort and security on week-end trips or extended tours. And, just like a full-sized motorhome, your interest payment may be tax deductible. Best of all, it's handcrafted by Airstream, so you know you're getting the quality and value that have made Airstream a legend for over 60 years.

Warning: This information is intended as a guide only. Weights of individual vehicles may vary. Consult your Owner's manual for complete loading, weighing & towing instructions.

1996 Model Year B-Van Specifications

Chassis	Ford
GVWR—lbs. Front (Gross Vehicle Weight Rating)	4,200
GVWR—lbs. Rear (Gross Vehicle Weight Rating)	6,084
GVWR—E350 Cargo Van—lbs. (Gross Vehicle Weight Rating)	9,400
GCWR—lbs. (Gross Combined Weight Rating)	11,500
UVW—with Fuel—lbs. (Unloaded Vehicle Weight)	8,000
NCC—lbs. (Net Carrying Capacity)	1,400
WHEELBASE	138"
ENGINE (cubic inches)	351
FUEL TANK (gallons)	35
REAR END RATIO	3.54
TIRES, ALL-SEASON	LT-245/75R x 16E
EXTERIOR LENGTH	19' 8"
EXTERIOR WIDTH	6' 8"
EXTERIOR HEIGHT	9' 5"
EXTERIOR HEIGHT WITH AIR CONDITIONER	9' 11"

Automotive Equipment

- Automatic transmission/overdrive
- Tilt steering wheel
- Cruise control
- Dash air conditioner
- AM/FM stereo radio w/cassette and speakers
- Convenience group package
- Hi-back bucket seat
- Deluxe engine cover console
- Power mirrors
- Air bag in steering wheel
- 4-wheel anti-lock braking system

Systems

- 22.4-gallon fresh water tank
- 20-gallon grey water tank
- 21-gallon black water tank
- 12-volt interior lighting
- 35' power cord for 110-volt service
- 30-amp converter w/12-volt charger
- Pre-wired for roof air conditioning
- 6-gal. water heater/DSI
- Demand water pump system
- 9.8-gal. LPG tank
- 12,000 BTU furnace
- 3 cu. ft. Dometic® refrigerator (3-way)
- 2-burner range top

- Power range hood w/light
- 12-volt roof vent
- City water hook-up
- Lockable water tank fill
- Control panel monitoring system with LP gauge in range hood
- Pre-wired for solar battery charger

Living Area & Construction

- Oak hardwood frames & doors
- Oak vinyl paneling
- Side-walls insulated
- Sit down shower area w/foldette door
- Bath exhaust fan
- Rear curbside closet
- Storage below range top cabinet
- Cabinet storage/TV shelf over galley
- **NEW!** 6' 1 1/2" Galley w/drawers (formica countertop)
- Refrigerator cabinet w/opt. microwave above, additional storage above microwave cabinet
- Cabinet storage over sofa
- Stainless steel sink w/faucet
- 72" x 40" Convertible sofa w/seat belts
- Drop-in table
- 72" x 76" sleeping area over cab

- Bunk ladder
- Carpet throughout (except bathroom)
- Vinyl floor covering (bathroom area)
- Trim panels on all doors
- Fire extinguisher
- Sewer drain hose compartment
- Medicine cabinet w/mirror
- Reading lights over sofa
- Smoke detector
- Vinyl ceiling w/Ozite walls

Exterior Features

- Aerodynamic raised fiberglass top, color matched to van w/1-piece front window
- Stylish exterior graphics
- Chrome front & rear bumpers
- Tinted, slide-open safety glass
- Windows w/screens
- Rear ladder
- Rack-type roof antenna w/jack
- Color coordinated ground effect running boards
- Continental kit w/spare tire & bracket
- Exterior storage or generator compartment
- Center brake light
- Porch light
- Sport wheel covers

Options

- Fabric selections
- 460 cu. in. engine, GCWR 15,000lbs.
- Double sink
- Generator 2.8 KW w/hour meter
- 11,000 BTU roof air conditioner w/heat strip
- 2nd coach battery
- Driving lights
- Towing package (receiver and wiring)
- Awning
- Power seat—driver
- Power seat—passenger
- Compact microwave
- 3-burner range w/oven
- Upgrade hi-back seat
- TV antenna booster w/cable TV and telephone hook-up
- Water purifier w/separate faucet
- Fan-Tastic® roof vent
- CB radio
- Galley flip-up shelf (Galley length 7' 1 1/2")
- 110-V exterior outlet
- Stow-a-way table

Since Airstream constantly strives to improve its product, all specifications are subject to change without notice.

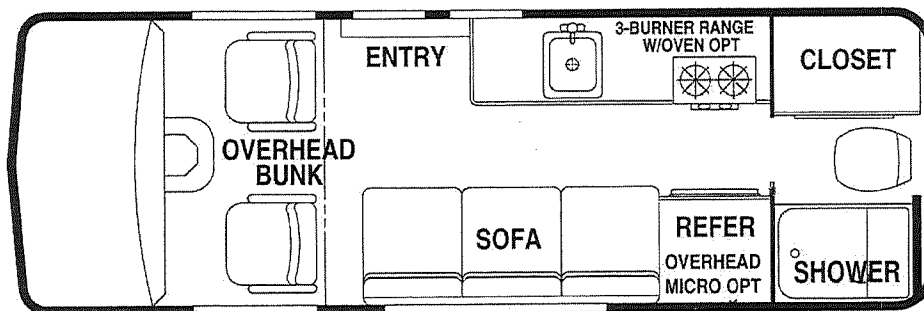

Vehicle Loading—Every effort has been made to provide the greatest number of options for the motorhome owner. Along with these choices comes the responsibility to manage the loads that are imposed by the choices so that they remain within the manufacturer's specified chassis weight limits. Do not overload the motorhome.

Dry weights based on standard features; optional equipment not included. Carrying capacity determined by subtracting dry gross weight from GVWR and includes fluids, options and cargo. Liquid capacities and weights are approximations only.



THOR
AMERICA'S BEST RV VALUE



This brochure is printed on recycled paper as part of Thor's corporate effort to minimize waste and conserve our natural resources. Providing safe, fuel efficient recreational vehicles is Thor's way of further demonstrating our role as the industry leader in safeguarding our nation's environment.

AIRSTREAM

419 W. Pike St • Jackson Center, OH 45334 • (513) 596-6111



**completely
Redesigned**

AIRSTREAM 190

Check Out All These Great Features!

AUTOMOTIVE EQUIPMENT

- NEW! Ford V-10 Triton Engine
- NEW! Passenger air bag
- Automatic transmission/overdrive
- Tilt steering wheel
- Cruise control
- Dash air conditioner
- AM/FM stereo radio w/cassette and speakers
- Convenience group package
- Hi-back bucket seat
- Deluxe engine cover console
- Power mirrors
- Air bag in steering wheel
- 4-wheel anti-lock braking system

SYSTEMS

- NEW! 22.4-gal. Fresh water tank
- NEW! 27.5-gal. Grey water tank
- NEW! 9-gal. Black water tank
- NEW! Heated holding tanks
- 12-volt interior lighting
- 110-V exterior outlet
- 35' power cord for 110-volt service
- 30-amp converter w/12-volt charger
- 11,000 BTU roof air conditioner w/heat strip
- 6-gal. water heater/DSI
- Demand water pump system
- 9.8-gal. LPG tank
- 12,000 BTU furnace
- 3 cu. ft. Dometic® refrigerator

(3-way)

- 3-burner range w/oven
- Power range hood w/light
- City water hook-up
- Lockable water tank fill
- Control panel monitoring system with LP gauge in range hood
- TV antenna booster w/cable TV and telephone hook-up
- TV antenna mounted in roof
- Pre-wired for solar battery charger
- Pre-wire generator kit

LIVING AREA & CONSTRUCTION

- NEW! Swivel passenger Seat
- NEW! Rear curbside closet
- NEW! 6' 1 1/2" Galley w/drawers (formica countertop)
- NEW! Fitted foam flooring
- NEW! Expandable curtains
- NEW! Larger Sewer drain hose compartment
- NEW! Larger medicine cabinet w/mirrors
- NEW! Fiberglass wet shower w/sink
- Power seat—driver
- Oak hardwood frames & doors
- Oak vinyl paneling
- Side-walls insulated
- Foldette door
- Bath exhaust fan

- Cabinet storage/TV shelf over galley
- Refrigerator cabinet w/opt. microwave above, additional storage above microwave cabinet
- Cabinet storage over sofa
- Stainless steel sink w/faucet
- 72" x 40" Convertible sofa w/seat belts
- Double sink
- Dining table w/o pedestal
- Galley flip-up shelf (Galley length 7' 1 1/2")
- Sleeping area over cab
- Bunk ladder
- Carpet throughout
- Trim panels on all doors
- Fire extinguisher
- Reading lights over sofa
- Smoke detector
- Vinyl ceiling w/Ozite walls
- Fan-Tastic® roof vent w/wall thermostat

EXTERIOR FEATURES

- NEW! Stylish exterior graphics
- NEW! Aerodynamic raised fiberglass top, color matched to van w/1-piece front window
- NEW! Color coordinated ground effect running boards
- NEW! Spare tire & bracket inside rear doors
- NEW! Roadside exterior storage

in running board below floor

- NEW! Center brake light
- Chrome front & rear bumpers
- Tinted, slide-open safety glass
- Windows w/screens
- Towing package (receiver and wiring)
- Exterior storage or generator compartment
- Porch light
- Sport wheel covers

OPTIONS

- Fabric selections
- Generator 2.8 KW w/hour meter
- Awning
- Compact microwave
- California emission engine

Since Airstream constantly strives to improve its product, all specifications are subject to change without notice.

Vehicle Loading—Every effort has been made to provide the greatest number of options for the motorhome owner. Along with these choices comes the responsibility to manage the loads that are imposed by the choices so that they remain within the manufacturer's specified chassis weight limits. Do not overload the motorhome.

Dry weights based on standard features; optional equipment not included. Carrying capacity determined by subtracting dry gross weight from GVWR and includes fluids, options and cargo. Liquid capacities and weights are approximations only.



This brochure is printed on recycled paper as part of Thor's corporate effort to minimize waste and conserve our natural resources. Providing safe, fuel efficient recreational vehicles is Thor's way of further demonstrating our role as the industry leader in safeguarding our nation's environment.



THOR
AMERICA'S BEST RV VALUE

AIRSTREAM

419 W. Pike St. • P.O. Box 629 • Jackson Center, OH 45334-0629 • 937-596-6111



Class "A" Features—B-Van Convenience!

The Airstream 190 is truly the all-purpose vehicle for today's demanding lifestyles: a deluxe 19' motorhome, a spacious second car, and a powerful tow vehicle. Full interior headroom, a complete kitchen and bath, and sleeping for four means your family can travel in comfort and security on weekend trips or extended tours. And we've made more than 20 great improvements, including an all-new bathroom, exterior storage, and a more aerodynamically efficient cab-over design. **And, of course, the Airstream 190 is covered by Thor's exclusive "2+2" warranty; 2-year structural and 2 years on major components.**

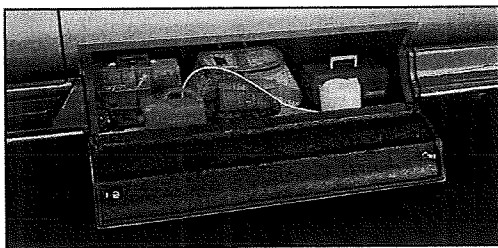

1997 MODEL YEAR B-VAN SPECIFICATIONS

CHASSIS	FORD
GVWR—lbs. Front (Gross Vehicle Weight Rating)	3,800
GVWR—lbs. Rear (Gross Vehicle Weight Rating)	6,084
GVWR—E350 Cargo Van—lbs. (Gross Vehicle Weight Rating)	9,400
GCWR—lbs. (Gross Combined Weight Rating)	15,000
UVW—with Fuel—lbs. (Unloaded Vehicle Weight)	7,940
NCC—lbs. (Net Carrying Capacity)	1,460
WHEELBASE	138"
ENGINE [cubic inches]	6.8L SEFI TRITON V-10
FUEL TANK [gallons]	35
REAR END RATIO	3.55
TIRES, ALL-SEASON	LT-245/75R x 16E
EXTERIOR LENGTH	19' 4"
EXTERIOR WIDTH	6' 8"
EXTERIOR HEIGHT	9' 5"
EXTERIOR HEIGHT WITH AIR CONDITIONER	9' 11"

Warning: This information is intended as a guide only. Weights of individual vehicles may vary. Consult your Owner's manual for complete loading, weighing & towing instructions.

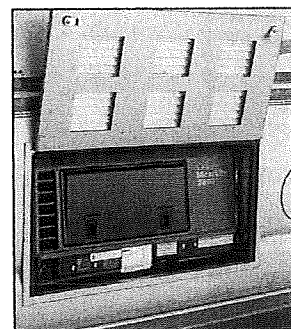
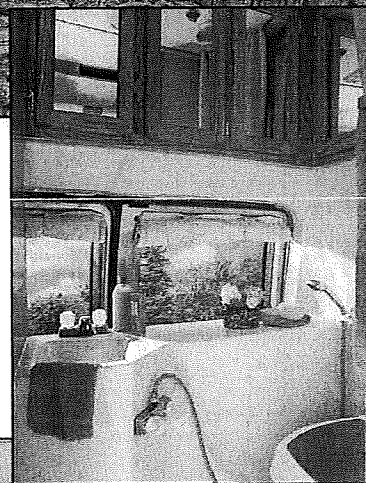

New Floorplan

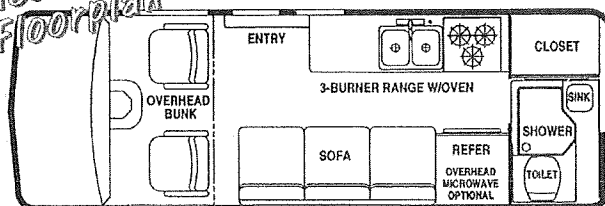

Exterior storage compartment/generator compartment and generator are not available with optional 2-seater dinette.

New Bathroom

1997

INTRODUCING THE 1997 NEW DESIGN - 190 B-VAN by Airstream

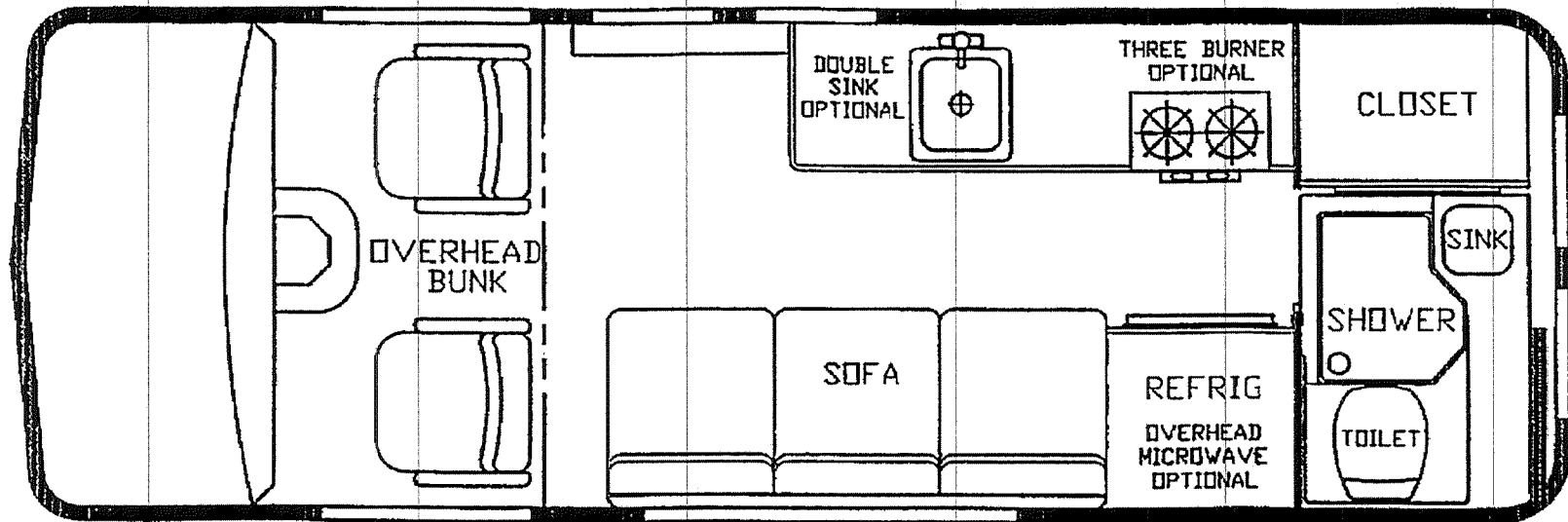

1997 - AIRSTREAM "190" MOTORHOME STANDARD FEATURES

AIRSTREAM
419 West Pike Street
Jackson Center, OH 45334
513-596-6111

CHASSIS

- Ford 9300 GVWR E350 Cargo Van w/Automatic 4-Speed Transmission w/Overdrive
- 138" Wheelbase
- 35 Gallon (132.5L) Fuel Tank
- 3.54 Rear End Ratio
- Handling Package
- 130 Amp Alternator
- Insulation Package, Deluxe
- LT 245/75R X 16E BSW All Season Tires
- Anti-Lock Brakes

EXTERIOR FEATURES

- Towing Package
- 110V Exterior Outlet
- Aerodynamic Raised Fiberglass Top with Front 1-Pc. Window - Color Matched To Van
- Exterior Graphics
- Chrome Front & Rear Bumpers
- Tinted, Slide-Open Safety Glass Windows w/Screens
- Color Coordinated Ground Effect Running Boards
- Spare Tire & Bracket Located Inside Rear Door
- Roadside Exterior Storage Compartment Below Floor
- Center Brake Light
- Sport Wheel Covers

AUTOMOTIVE EQUIPMENT

- Swing Out Glass Side, Rear, Cargo Doors
- Windshield Wipers, Interval
- Power Door Locks & Windows
- Tilt Steering Wheel
- Cruise Control
- Dash Air Conditioner
- AM/FM/Cassette & Speakers
- Convenience Group Package
- Deluxe Engine Cover Console
- Driver/Passenger Air Bags

SYSTEMS

- 11,000 BTU Air Conditioner w/Heat Strip
- Fantastic Roof Vent
- Generator Prep Kit w/o Hour Meter
- TV Antenna Mounted in Roof
- 12 Volt Interior Lighting
- 35' Power Cord 110V Service
- 30 Amp Converter w/12 Volt Charger
- 23 Gallon Fresh Water
- 6 Gallon Quick Recovery Hot Water Heater
- 27.5 Gallon Grey Water Tank
- 9 Gallon Black Water Tank
- Demand Water Pump System
- 9.8 Gallon LPG Tank
- 12,000 BTU Furnace
- 3 cu. ft. Refrigerator
- Lockable Water Tank Fill
- Power Range Hood w/Light & Control Panel
- City Water Hook-Up
- Porch Light
- Pre-Wire For Solar Battery Charger

LIVING AREA & CONSTRUCTION

- Oak Hardwood Frames & Doors
- Oak Vinyl Paneling
- Insulated Side-Walls
- Fiberglass Wet Shower w/Sink
- Bathroom Exhaust Fan
- Rear C.S. Closet
- 3-Burner Cooktop w/Oven
- Cabinet Storage Over Sofa
- Double Stainless Steel Sink w/High-Rise Faucet
- Flip-Up Galley Shelf
- Convertible Sofa w/Seat Belts
- Dining Table
- 55" x 64" Sleeping Area Over Cab
- Bunk Ladder
- Carpet Throughout (Except Bathroom)
- Deluxe Power Driver Seat
- Deluxe Passenger Seat (Manual)
- Trim Panels On All Doors
- Fire Extinguisher
- Sewer Drain Hose & Holder
- Ozite Ceiling
- Medicine Cabinet w/Mirror

1/16/971

1998 - AIRSTREAM "190" MOTORHOME STANDARD FEATURES

AIRSTREAM

419 West Pike Street
Jackson Center, OH 45334
937-596-6111

CHASSIS

- Ford 9400 GVWR E350 Cargo Van w/Automatic 4-Speed Transmission w/Overdrive
- 138" Wheelbase
- 35 Gallon (132.5L) Fuel Tank
- 3.54 Rear End Ratio
- Handling Package
- 130 Amp Alternator
- Insulation Package, Deluxe
- LT 245/75R X 16E BSW All Season Tires
- Anti-Lock Brakes - 4 Wheels

EXTERIOR FEATURES

- Towing Package
- 110V Exterior Outlet
- Aerodynamic Raised Fiberglass Top with Front 1-Pc. Window - Color Matched To Van
- Exterior Graphics
- Chrome Front & Rear Bumpers
- Tinted, Slide-Open Safety Glass Windows w/Screens
- Color Coordinated Ground Effect Running Boards
- Spare Tire & Bracket Located Inside Rear Door
- Roadside Exterior Storage Compartment Below Floor
- Center Brake Light
- Sport Wheel Covers

AUTOMOTIVE EQUIPMENT

- Swing Out Glass on Side Front Cargo Door
- Windshield Wipers, Interval
- Power Door Locks & Windows
- Tilt Steering Wheel
- Cruise Control
- Dash Air Conditioner
- AM/FM/Cassette & Speakers
- Convenience Group Package
- Deluxe Engine Cover Console
- Driver/Passenger Air Bags

SYSTEMS

- 11,000 BTU Air Conditioner w/Heat Strip
- Fantastic Roof Vent
- Generator Prep Kit w/o Hour Meter
- TV Antenna Mounted in Roof
- 12 Volt Interior Lighting
- 35' Power Cord 110V Service
- 30 Amp Converter w/12 Volt Charger
- 6 Gallon Quick Recovery Hot Water Heater
- 22.4 Gallon Fresh Water
- 21.2 Gallon Grey Water Tank
- 16.8 Gallon Black Water Tank
- Demand Water Pump System
- 9.8 Gallon LPG Tank
- 12,000 BTU Furnace
- 3 cu. ft. Refrigerator
- Lockable Water Tank Fill
- Power Range Hood w/Light & Control Panel
- City Water Hook-Up
- Porch Light
- Pre-Wire For Solar Battery Charger

LIVING AREA & CONSTRUCTION

- Oak Hardwood Frames & Doors
- Oak Vinyl Paneling
- Insulated Side-Walls
- Fiberglass Wet Shower w/Sink
- Bathroom Exhaust Fan
- Rear C.S. Closet
- 3-Burner Cooktop w/Oven
- Cabinet Storage Over Sofa
- Double Stainless Steel Sink w/High-Rise Faucet
- Flip-Up Galley Shelf
- Enhanced Galley Top w/Oak Trim
- Convertible Sofa w/Seat Belts
- Dining Table
- 55" x 64" Sleeping Area Over Cap
- Bunk Ladder
- Carpet Throughout
- Deluxe Power Driver Seat
- Deluxe Passenger Seat (Manual)
- Trim Panels On All Doors
- Fire Extinguisher
- Sewer Drain Hose & Holder
- Ozite Walls/Vinyl Ceiling
- Medicine Cabinet w/Mirror

12/01/97

1999 - AIRSTREAM 190 MH STANDARD FEATURES

CHASSIS

rd 9400 GVWR E-350 Cargo Van w/Automatic
4-Speed Transmission w/Overdrive
8" Wheelbase
Gallon (132.5L) Fuel Tank
54 Rear End Ratio
ndling Package
10 Amp Alternator
sulation Package, Deluxe
245/75R x 16E BSW All Season Tires
sti-Lock Brakes - 4 Wheels

AUTOMOTIVE EQUIPMENT

Swing-Out Glass on Side Front Cargo Door
Windshield Wipers, Interval
Power Door Locks & Windows
Tilt Steering Wheel
Cruise Control
Dash Air Conditioner
AM/FM/Cassette & Speakers
Convenience Group Package
Deluxe Engine Cover Console
Driver/Passenger Air Bags
Map Light in Driver's Area

LIVING AREA & CONSTRUCTION

Oak Hardwood Frames & Doors
Oak Vinyl Paneling
Insulated Side-Walls
Fiberglass Wet Shower w/Sink
Bathroom Exhaust Fan
Rear C.S. Closet
3-Burner Cooktop w/Oven
Cabinet Storage Over Sofa
Double Stainless Steel Sink
Adjustable Galley Shelf
Enhanced Galley Top w/Oak Trim
Convertible Sofa w/Seatbelts - 46" x 72"
Dining Table w/Drink Holder (Mounts on Galley

EXTERIOR FEATURES

wing Package
10V Exterior Outlet
erodynamic Raised Fiberglass Top w/Front 1-pc
Window - Color Matched to Van
terior Graphics
hrome Front & Rear Bumpers
inted Slide-Open Safety Glass Windows w/Screens
olor Coordinated Ground Effect Running Boards
pare Tire w/Bracket Located Inside Rear Door
.S. Exterior Storage Compartment Below Floor
enter Brake Light
port Wheel Covers

SYSTEMS

11,000 BTU Air Conditioner w/Heat Strip
Fantastic Roof Vent
Generator Prep Kit w/Hour Meter
TV Antenna Mounted in Roof
12 Volt Interior Lighting
35' Power Cord 110V Service
30 Amp Converter w/12 Volt Charger
6 Gallon Water Heater, 110V/LPG
22.4 Gallon Fresh Water
21.2 Gallon Grey Water Tank
16.8 Gallon Black Water Tank
Demand Water Pump System
9.8 Gallon LPG Tank
12,000 BTU Furnace
3 Cu. Ft. Refrigerator
Lockable Water Tank Fill
Power Range Hood w/Light & Control Panel
City Water Hook-Up
Porch Light
Prewired for Solar Battery Charger

Doors)
65.5" x 80" Sleeping Area Over Cab
Bunk Ladder
Carpet Throughout
Deluxe Power Driver Seat
Deluxe Passenger Seat (Manual)
Trim Panels on All Doors
Fire Extinguisher
Sewer Drain Hose & Holder
Ozite Walls/Vinyl Ceiling
Medicine Cabinet w/Mirror

11/20/98

Specifications are subject to change without notification.